

Madison, Wisconsin

CITY OF MADISON

CITY ENGINEERING DIVISION

DEPARTMENT OF PUBLIC WORKS

PLAN OF PROPOSED IMPROVEMENT

INDEX OF SHEETS

SHEET NO.	LOCATION
1	TITLE SHEET
P-1	STREET PLAN & PROFILE- DONALD DR BUMPOUTS
P-2	STREET PLAN - DRAKE ST MEDIAN ISLAND
P-3	STREET PLAN - DRAKE ST SPEED HUMPS
P-4	STREET PLAN - N. FOURTH ST SPEED HUMPS
P-5	STREET PLAN - GREAT GRAY DR MEDIAN ISLANDS
P-6	STREET PLAN - MEADOWLARK DR SPEED HUMPS
P-7	STREET PLAN- MEADOWLARK DR SPEED HUMPS
P-8	STREET PLAN - MILKY WAY SPEED HUMPS
P-9	STREET PLAN - MILKY WAY SPEED HUMPS
P-10	STREET PLAN - MILKY WAY SPEED HUMPS
P-11	STREET PLAN - MOORLAND RD MEDIAN ISLAND
P-12	STREET PLAN - MUIR FIELD RD MEDIAN ISLAND
P-13	STREET PLAN - ODANA RD MEDIAN ISLAND
P-14	STREET PLAN - ODANA RD MEDIAN ISLAND
P-15	STREET PLAN - SCHOOL RD SPEED HUMPS
P-16	STREET PLAN - TOMPKINS DR SPEED HUMPS
P-17	STREET PLAN - TRACEWAY DR SPEED HUMPS
P-18	STREET PLAN - TRACEWAY DR SPEED HUMPS

NO MAINTENANCE PLAN

SAFE STREETS MADISON 2024

CITY PROJECT NO. 14199
CONTRACT NO. 8695

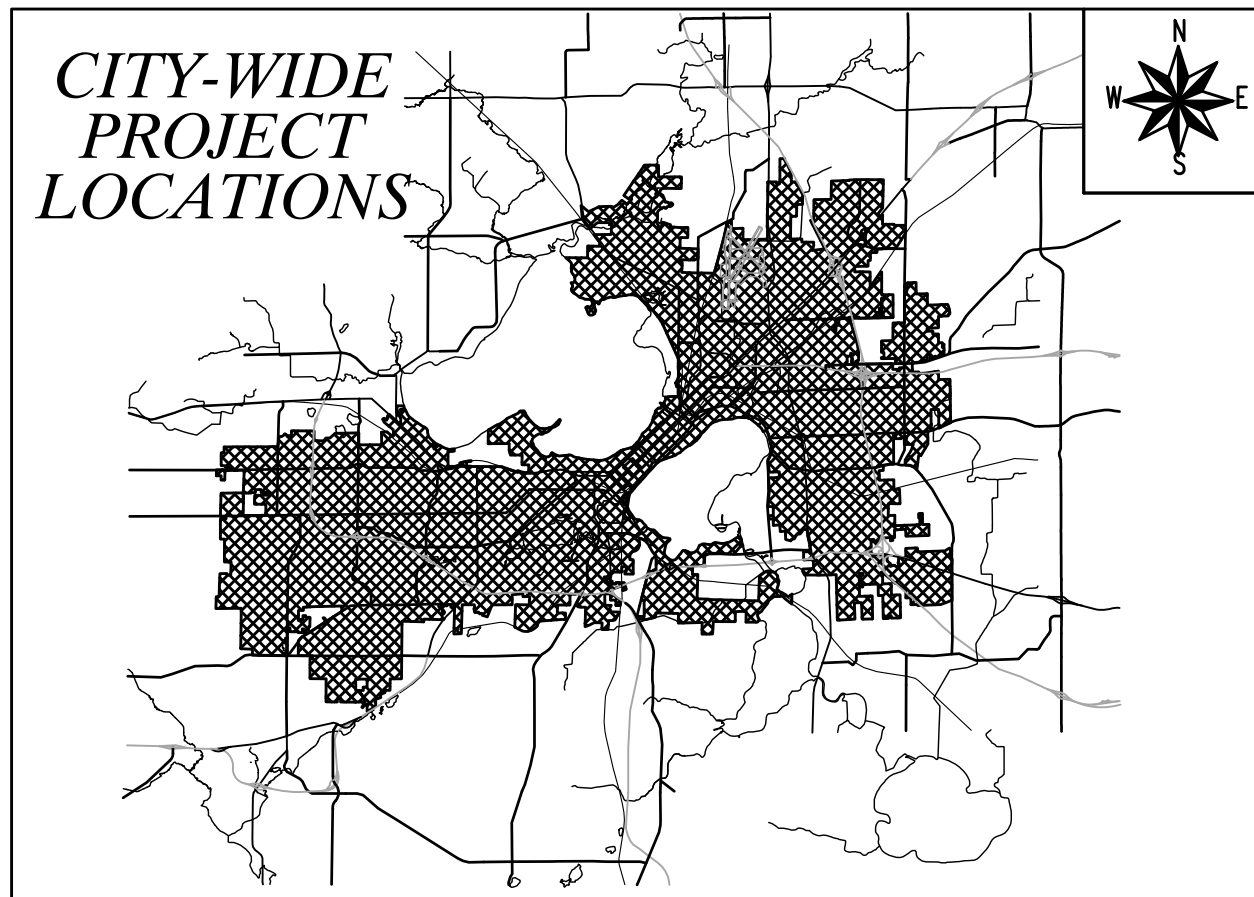

CONVENTIONAL SIGNS
FIELD VERIFY ALL UTILITY LOCATIONS

GAS	— G —
STORM SEWER	— ST —
SANITARY SEWER	— SAN —
WATER	— W —
BURIED ELECTRIC	— E —
OVERHEAD ELECTRIC	— OH —
POWER POLE	□
ADA COMPLIANT RAMP W/ DETECTABLE WARNING FIELD	▤
COMBUSTIBLE FLUIDS	☀

EARTH WORK SUMMARY:
EXCAVATION CUT(MEASURED PLAN QUANTITY) = 512 C.Y.
ESTIMATED UNDISTRIBUTED UNDERCUT = 0 C.Y.
TOTAL UNCLASSIFIED EXCAVATION CUT = 512 C.Y.

NOTES:

- STRAIGHT LINE PAVEMENT SAWCUTS WILL BE FIELD MARKED IN INSTANCES WHERE CURVES ARE SHOWN ON MEDIAN PLANS.
- ALL GUTTERS SHALL DRAIN WITH A MINIMUM GRADE OF 0.50% TOWARD STORM SEWER INLETS.
- SIDEWALK RAMPS AND CURB THRU SIDEWALK RAMPS SHALL HAVE A MAXIMUM SLOPE OF 1" PER 12", SIDEWALK AND CURB RAMPS SHALL BE CONSTRUCTED WITH A SIDE SLOPE OF 1.50%. SIDEWALK SHALL HAVE A MINIMUM LONGITUDINAL SLOPE OF 0.50% AND A MAXIMUM LONGITUDINAL SLOPE OF 5.00% EXCEPT WHERE STREET GRADES EXCEED 5.00%.

PUBLIC IMPROVEMENT PROJECT APPROVED

APPROVED DATE: FEBRUARY 13, 2024

BY THE COMMON COUNCIL OF MADISON, WISCONSIN

PUBLIC IMPROVEMENT DESIGN APPROVED BY:



Mar 29, 2024

City Engineer

Date

GEOMETRICS & PAVEMENT MARKINGS DESIGNED BY:

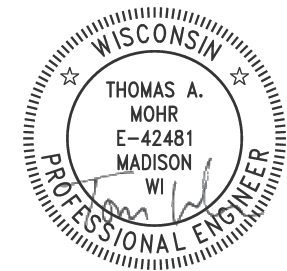

Mar 29, 2024

STREET GRADES DESIGNED BY:



Mar 29, 2024

PLOT SCALE: 1 IN=1 FT_XREF
PLOT NAME: —
REV. DATE: 3/28/2024 6:32 PM
ORIGINATOR: CITY_OF_MADISON

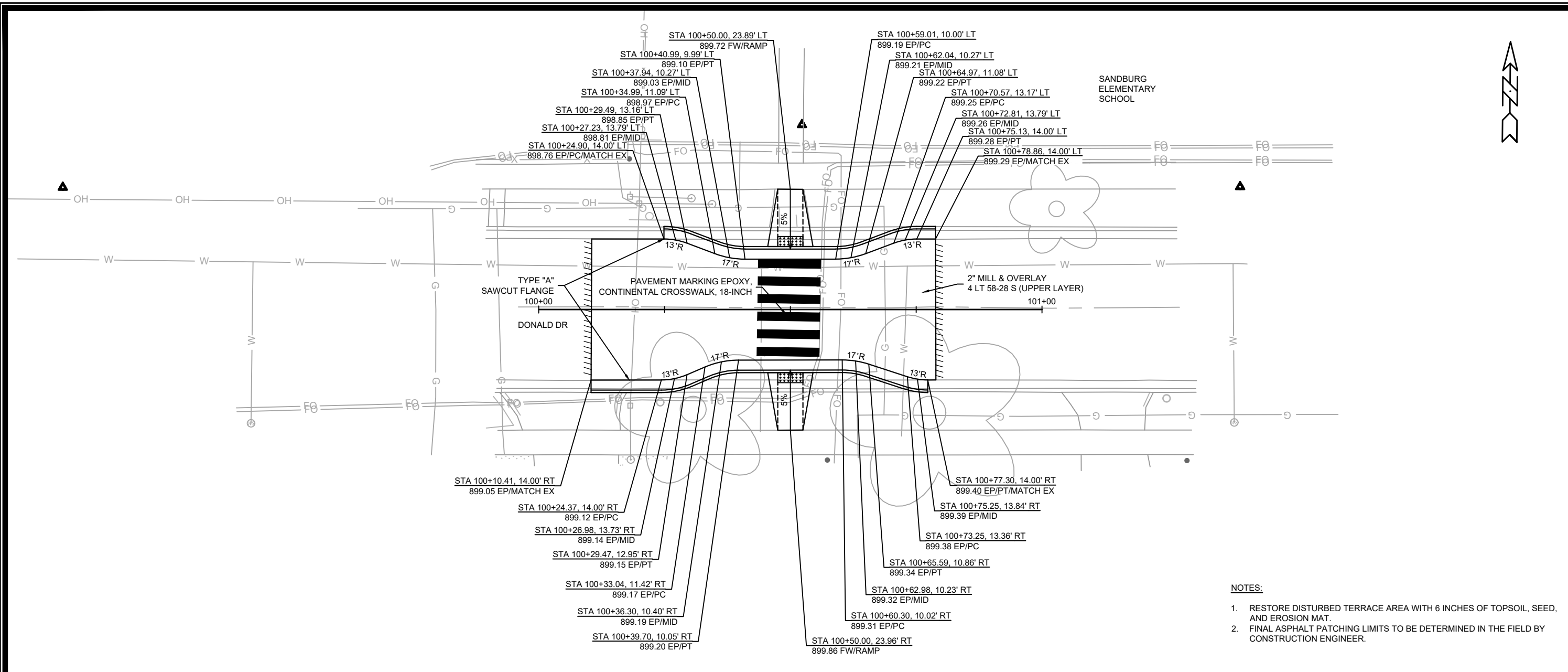

SANDBURG
ELEMENTARY
SCHOOL

NOTES:

1. RESTORE DISTURBED TERRACE AREA WITH 6 INCHES OF TOPSOIL, SEED, AND EROSION MAT.
2. FINAL ASPHALT PATCHING LIMITS TO BE DETERMINED IN THE FIELD BY CONSTRUCTION ENGINEER.

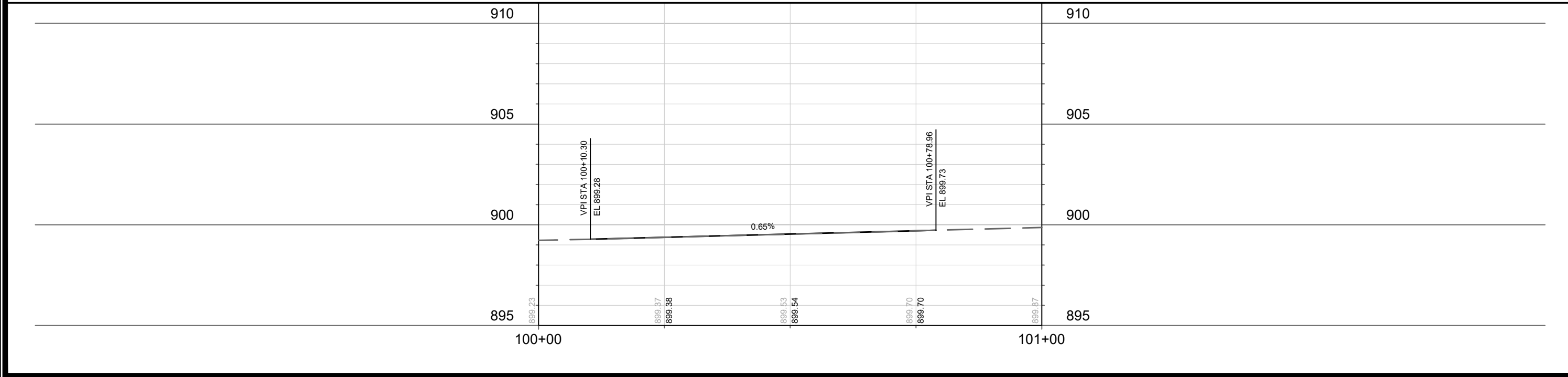

MARK	REVISION	DATE	BY

14199
MADISON, WI
CONTRACT NO: 8695

STREET PLAN & PROFILE - DONALD DR
SAFE STREETS MADISON 2024
M:\DESIGN\Projects\14199\CAD\Streets\14199EN-Corridor.dwg



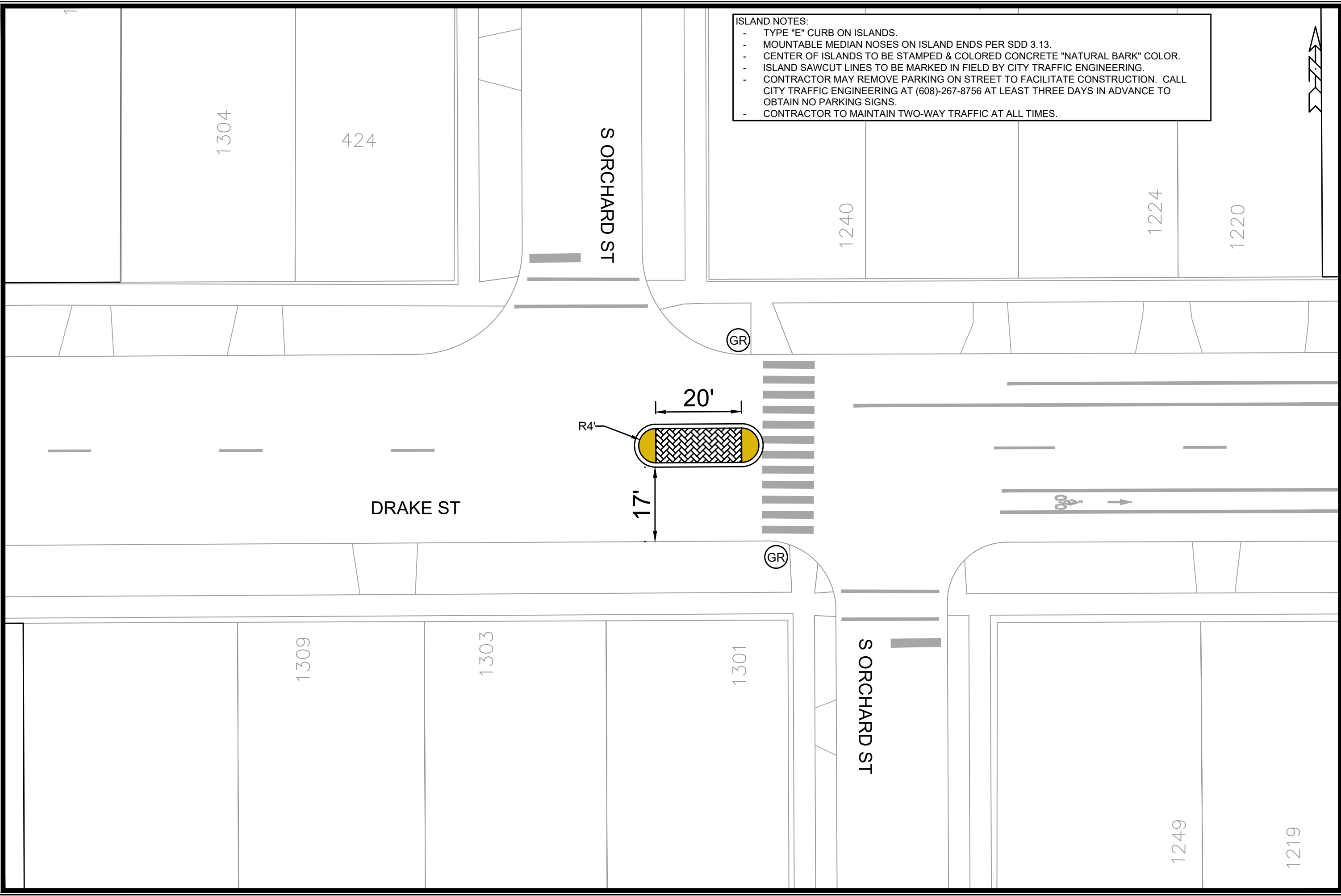

ISLAND NOTES:

- TYPE "E" CURB ON ISLANDS.
- MOUNTABLE MEDIAN NOSES ON ISLAND ENDS PER SDD 3.13.
- CENTER OF ISLANDS TO BE STAMPED & COLORED CONCRETE "NATURAL BARK" COLOR.
- ISLAND SAWCUT LINES TO BE MARKED IN FIELD BY CITY TRAFFIC ENGINEERING.
- CONTRACTOR MAY REMOVE PARKING ON STREET TO FACILITATE CONSTRUCTION. CALL CITY TRAFFIC ENGINEERING AT (608)-267-8756 AT LEAST THREE DAYS IN ADVANCE TO OBTAIN NO PARKING SIGNS.
- CONTRACTOR TO MAINTAIN TWO-WAY TRAFFIC AT ALL TIMES.

MARK	REVISION	DATE	BY

14199
 MADISON, WI
 8695
 CONTRACT NO:
 STREET PLAN - DRAKE ST
 SAFE STREETS MADISON 2024
 M:\DESIGN\Projects\14199\CAD\Traffic\SSM 2024 - JAN\Safe Streets Madison 2024-14199 JAN.dwg



14199
 P-2

Designed By: JAN
 Date: 3/28/2024 6:34 PM
 Scale: 1/20
 P-2

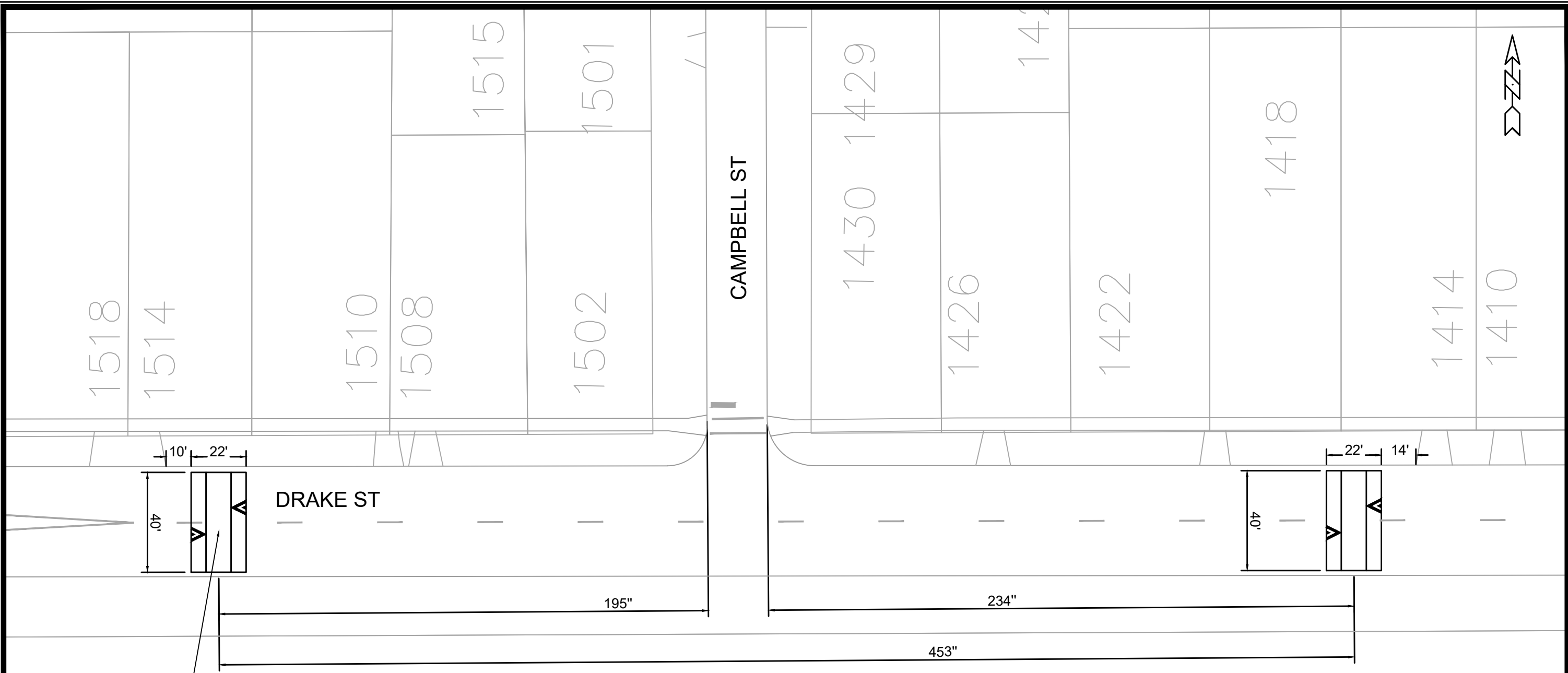

USE "MODIFIED SPEED HUMP CROSS SECTION" DETAIL AS SHOWN BELOW

- NOTES:
- SPEED HUMP SAWCUT LINES TO BE MARKED IN FIELD BY CITY TRAFFIC ENGINEERING.
 - CONTRACTOR MAY REMOVE PARKING ON STREET TO FACILITATE CONSTRUCTION. CALL CITY TRAFFIC ENGINEERING AT (608) 267-8756 AT LEAST THREE DAYS IN ADVANCE TO OBTAIN NO PARKING SIGNS.
 - CONTRACTOR TO MAINTAIN TWO-WAY TRAFFIC AT ALL TIMES.
 - SPEED HUMPS TO BE CONSTRUCTED PER S.D.D. 4.10.
 - PLACE TEMPORARY STOP SIGNS ON EITHER SIDE OF EACH SPEED HUMP UNDER CONSTRUCTION WITH "TAKE TURN" SIGN PLAQUES.
 - PLACE ADVANCED WARNING SIGNS PER M.U.T.C.D. GUIDELINES.
 - WORK TO TAKE PLACE MONDAY THRU FRIDAY, 7AM TO 7PM.
 - EPOXY ARROW TO BE CENTERED IN DRIVE LANE.
 - SPEED HUMPS TO BE CONSTRUCTED IN HALVES TO MAINTAIN TWO-WAY TRAFFIC AT ALL TIMES.
 - CONTRACTOR TO PROTECT ALL EXISTING TREES.

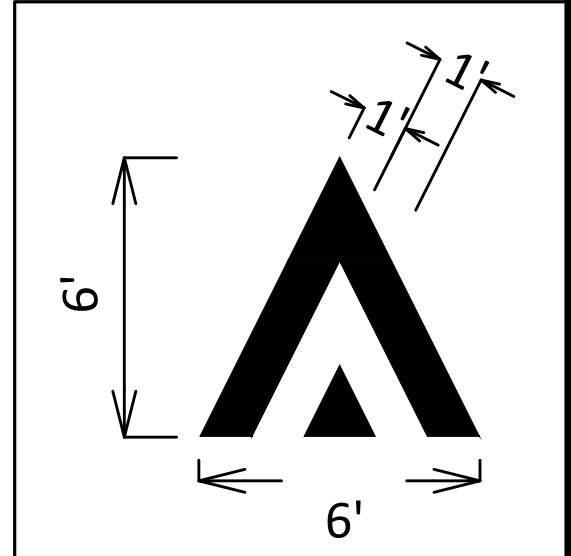
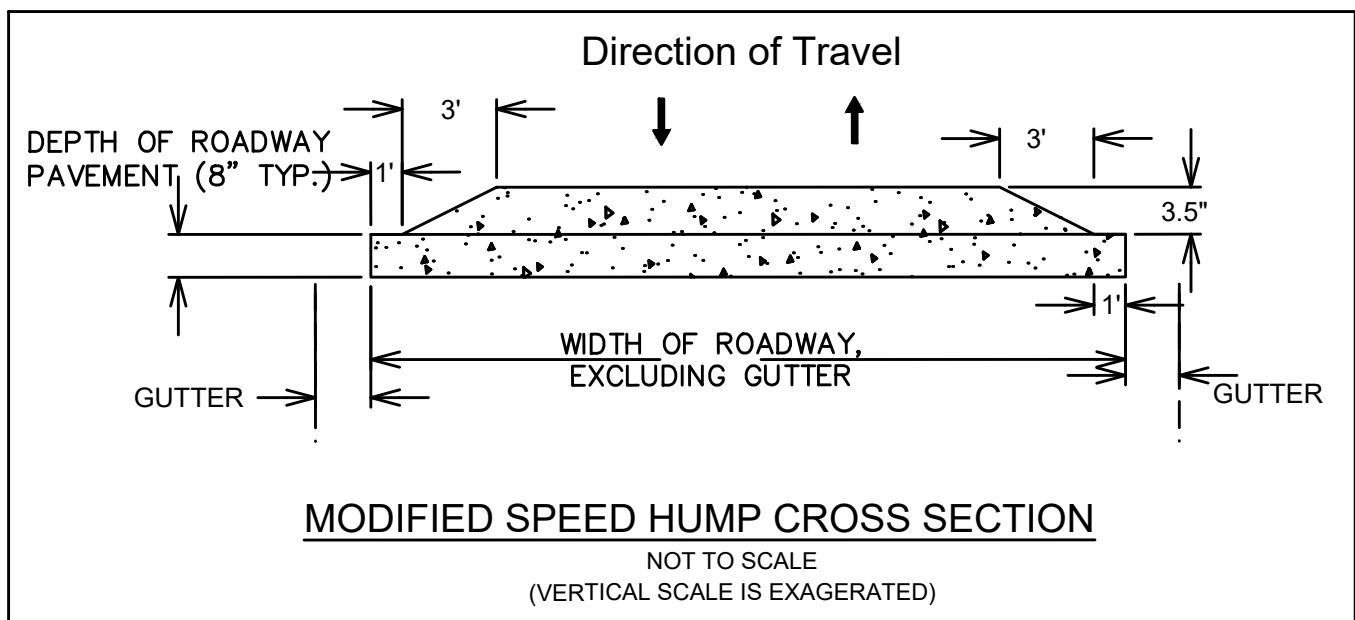

14199	MADISON, WI	8695	CONTRACT NO:								
STREET PLAN - DRAKE ST											
SAFE STREETS MADISON 2024											
M:\DESIGN\Projects\14199\CAD\Traffic\SSM 2024 - JAN\Safe Streets Madison 2024 - 14199 JAN.dwg											
<table border="1" style="width: 100%; border-collapse: collapse;"> <tr> <th style="width: 5%;">NO.</th> <th style="width: 15%;">REVISION</th> <th style="width: 15%;">DATE</th> <th style="width: 15%;">BY</th> </tr> <tr> <td> </td> <td> </td> <td> </td> <td> </td> </tr> </table>				NO.	REVISION	DATE	BY				
NO.	REVISION	DATE	BY								
14199		P-3									

- ISLAND NOTES:**
- TYPE "E" CURB ON ISLANDS.
 - MOUNTABLE MEDIAN NOSES ON ISLAND ENDS PER SDD 3.13.
 - CENTER OF ISLANDS TO BE STAMPED & COLORED CONCRETE "NATURAL BARK" COLOR.
 - ISLAND SAWCUT LINES TO BE MARKED IN FIELD BY CITY TRAFFIC ENGINEERING.
 - CONTRACTOR MAY REMOVE PARKING ON STREET TO FACILITATE CONSTRUCTION. CALL CITY TRAFFIC ENGINEERING AT (608)-267-8756 AT LEAST THREE DAYS IN ADVANCE TO OBTAIN NO PARKING SIGNS.
 - CONTRACTOR TO MAINTAIN TWO-WAY TRAFFIC AT ALL TIMES.

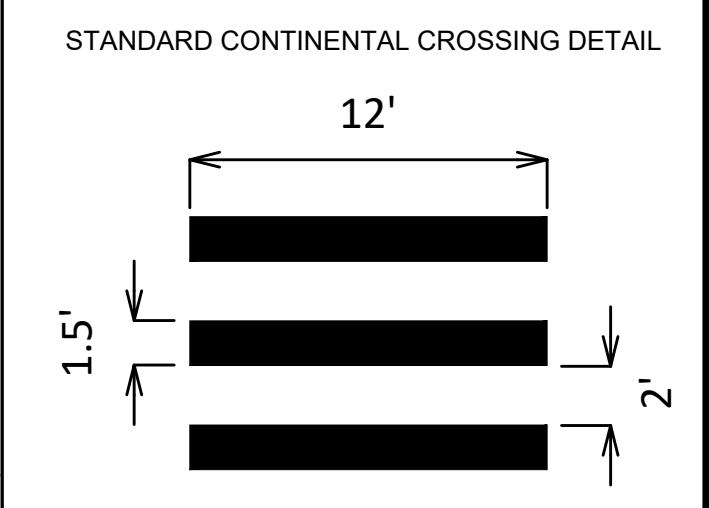
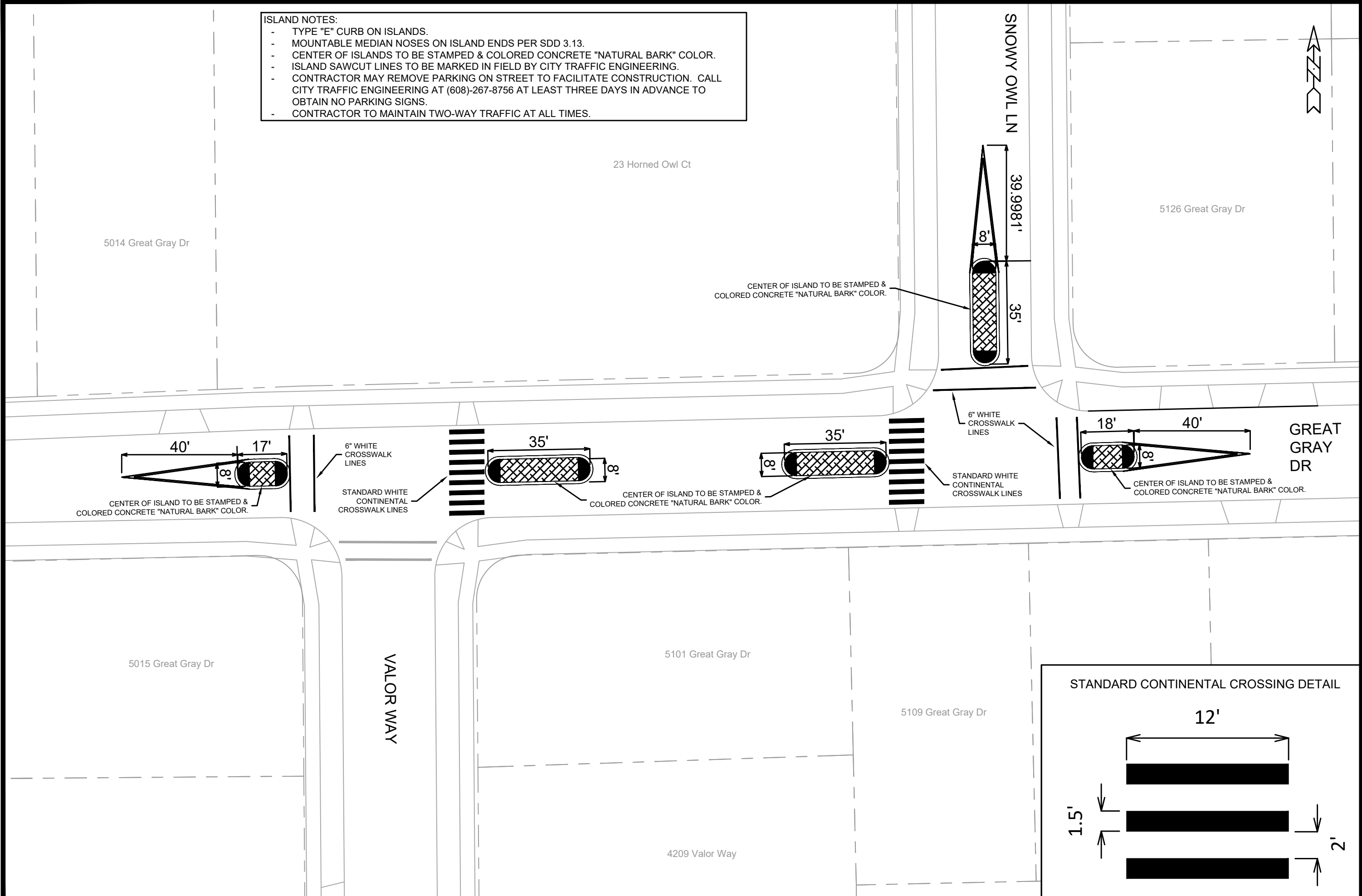

MARK	REVISION	DATE	BY
14199	14199	3/28/2024 6:38 PM	LMC

14199
MADISON, WI
8695
CONTRACT NO:

STREET PLAN - GREAT GRAY DR
SAFE STREETS MADISON 2024
M:\DESIGN\Projects\14199\CAD\Traffic\SSM 2024 - LMC\Owl Creek Park - SSM 2024.dwg



14199
P-5

- NOTES:
- SPEED HUMP SAWCUT LINES TO BE MARKED IN FIELD BY CITY TRAFFIC ENGINEERING.
 - CONTRACTOR MAY REMOVE PARKING ON STREET TO FACILITATE CONSTRUCTION. CALL CITY TRAFFIC ENGINEERING AT (608) 267-8756 AT LEAST THREE DAYS IN ADVANCE TO OBTAIN NO PARKING SIGNS.
 - CONTRACTOR TO MAINTAIN TWO-WAY TRAFFIC AT ALL TIMES.
 - SPEED HUMPS TO BE CONSTRUCTED PER S.D.D. 4.10.
 - SPEED HUMPS TO BE CONSTRUCTED DURING SUMMER BREAK (MIDDLE OF JUNE TO END OF AUGUST).
 - PLACE TEMPORARY STOP SIGNS ON EITHER SIDE OF EACH SPEED HUMP UNDER SCONSTRUCTION WITH "TAKE TURN" SIGN PLAQUES.
 - PLACE ADVANCED WARNING SIGNS PER M.U.T.C.D. GUIDELINES.
 - WORK TO TAKE PLACE MONDAY THRU FRIDAY, 7AM TO 7PM.
 - EPOXY ARROW TO BE CENTERED IN DRIVE LANE.
 - SPEED HUMPS TO BE CONSTRUCTED IN HALVES TO MAINTAIN TWO-WAY TRAFFIC AT ALL TIMES.
 - CONTRACTOR TO PROTECT ALL EXISTING TREES.

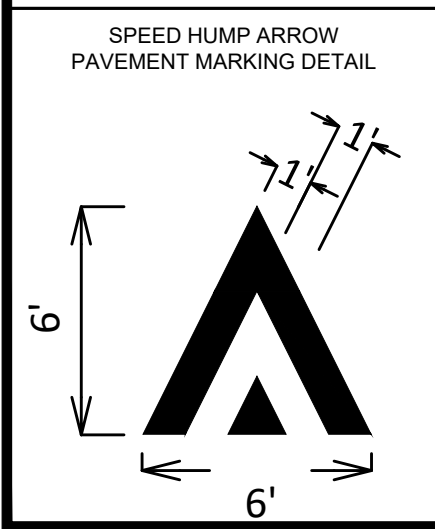
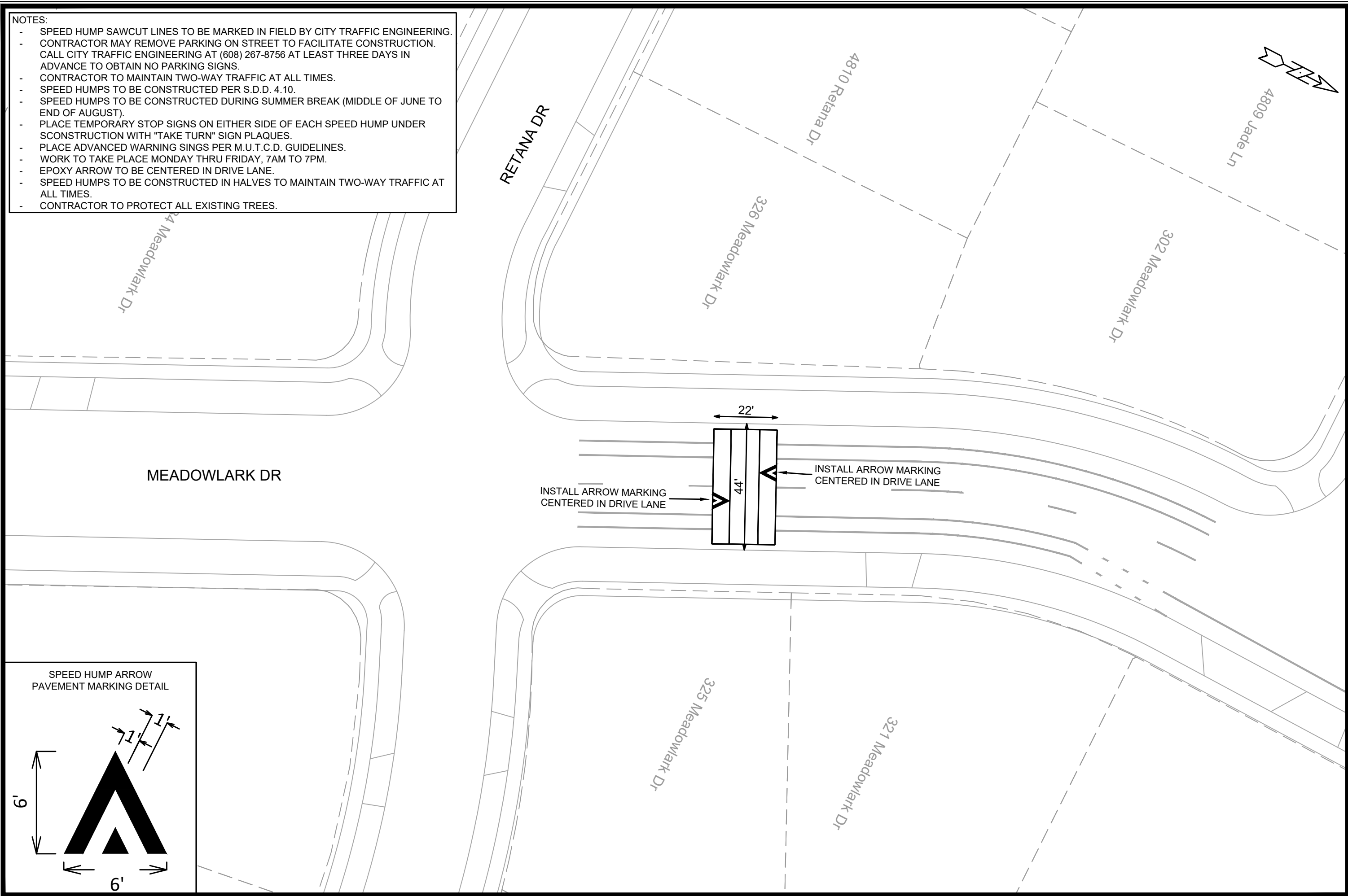

MARK	REVISION	DATE	BY
14199	3/28/2024	6:39 PM	

Scale: 1:30

14199
MADISON, WI
8695
CONTRACT NO:

STREET PLAN - MEADOWLARK DR
SAFE STREETS MADISON 2024

M:\DESIGN\Projects\14199\CAD\Traffic\SSM 2024 - LMC\Meadowlark Dr - Speed Humps - SSM 2024.dwg

14199
P-6

- NOTES:
- SPEED HUMP SAWCUT LINES TO BE MARKED IN FIELD BY CITY TRAFFIC ENGINEERING.
 - CONTRACTOR MAY REMOVE PARKING ON STREET TO FACILITATE CONSTRUCTION. CALL CITY TRAFFIC ENGINEERING AT (608) 267-8756 AT LEAST THREE DAYS IN ADVANCE TO OBTAIN NO PARKING SIGNS.
 - CONTRACTOR TO MAINTAIN TWO-WAY TRAFFIC AT ALL TIMES.
 - SPEED HUMPS TO BE CONSTRUCTED PER S.D.D. 4.10.
 - SPEED HUMPS TO BE CONSTRUCTED DURING SUMMER BREAK (MIDDLE OF JUNE TO END OF AUGUST).
 - PLACE TEMPORARY STOP SIGNS ON EITHER SIDE OF EACH SPEED HUMP UNDER SCONSTRUCTION WITH "TAKE TURN" SIGN PLAQUES.
 - PLACE ADVANCED WARNING SIGNS PER M.U.T.C.D. GUIDELINES.
 - WORK TO TAKE PLACE MONDAY THRU FRIDAY, 7AM TO 7PM.
 - EPOXY ARROW TO BE CENTERED IN DRIVE LANE.
 - SPEED HUMPS TO BE CONSTRUCTED IN HALVES TO MAINTAIN TWO-WAY TRAFFIC AT ALL TIMES.
 - CONTRACTOR TO PROTECT ALL EXISTING TREES.

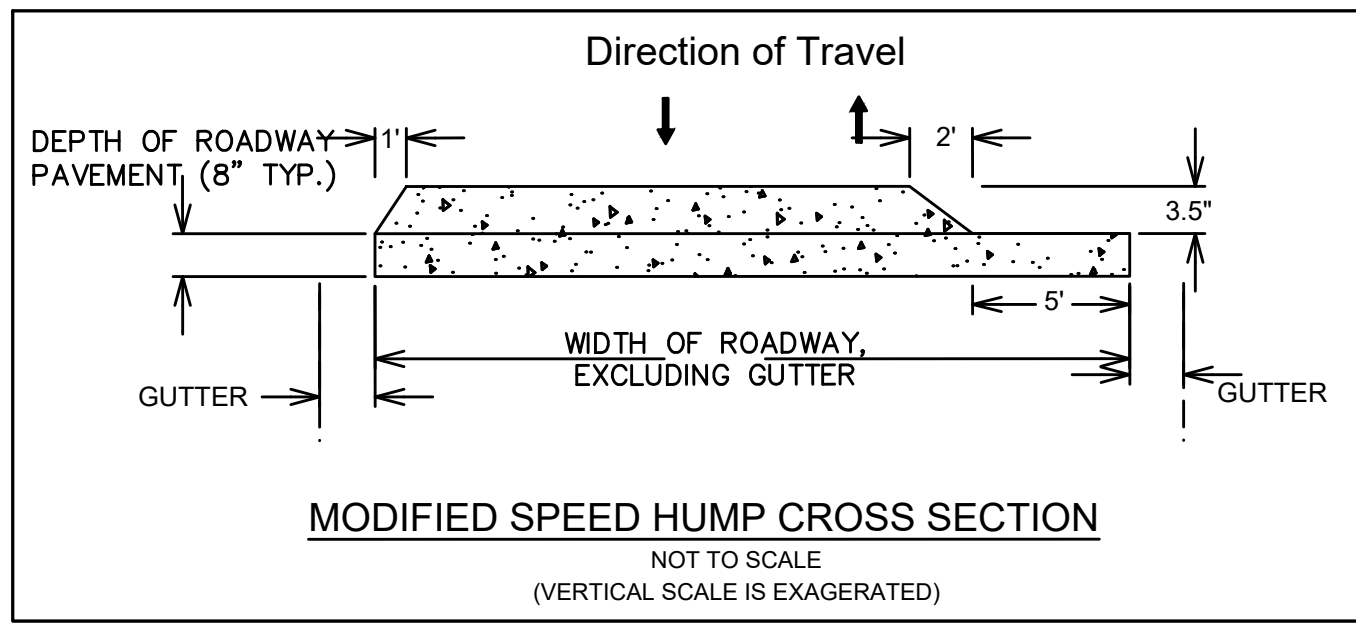
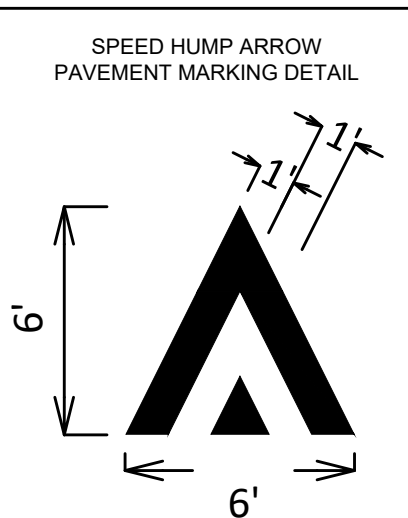
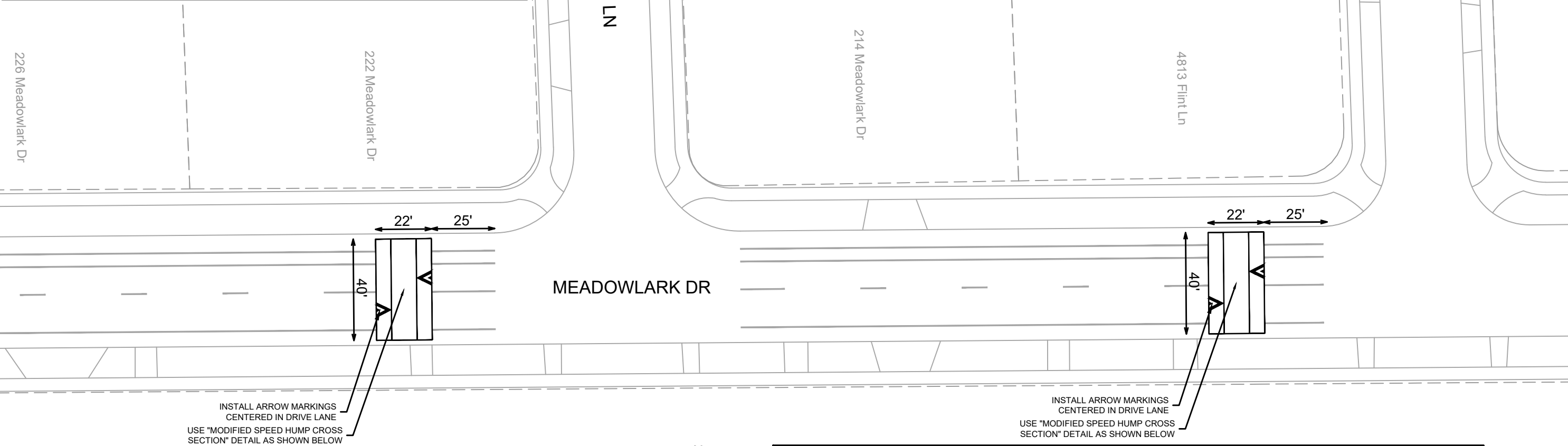

MARK	REVISION	DATE	BY
14199	14199	3/28/2024 6:41 PM	P-7

14199
MADISON, WI
8695
CONTRACT NO:
14199
SAFE STREETS MADISON 2024
M:\DESIGN\Projects\14199\CAD\Traffic\SSM 2024 - LMC\Meadowlark Dr - Speed Humps - SSM 2024.dwg



- NOTES:**
- SPEED HUMP SAWCUT LINES TO BE MARKED IN FIELD BY CITY TRAFFIC ENGINEERING.
 - CONTRACTOR MAY REMOVE PARKING ON STREET TO FACILITATE CONSTRUCTION. CALL CITY TRAFFIC ENGINEERING AT (608) 267-8756 AT LEAST THREE DAYS IN ADVANCE TO OBTAIN NO PARKING SIGNS.
 - CONTRACTOR TO MAINTAIN TWO-WAY TRAFFIC AT ALL TIMES.
 - SPEED HUMPS TO BE CONSTRUCTED PER S.D.D. 4.10.
 - PLACE TEMPORARY STOP SIGNS ON EITHER SIDE OF EACH SPEED HUMP UNDER SCONSTRUCTION WITH "TAKE TURN" SIGN PLAQUES.
 - PLACE ADVANCED WARNING SIGNS PER M.U.T.C.D. GUIDELINES.
 - WORK TO TAKE PLACE MONDAY THRU FRIDAY, 7AM TO 7PM.
 - EPOXY ARROW TO BE CENTERED IN DRIVE LANE.
 - SPEED HUMPS TO BE CONSTRUCTED IN HALVES TO MAINTAIN TWO-WAY TRAFFIC AT ALL TIMES.
 - CONTRACTOR TO PROTECT ALL EXISTING TREES.

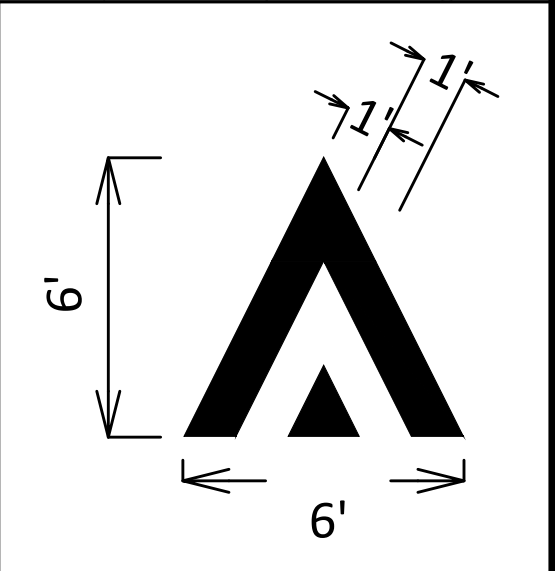
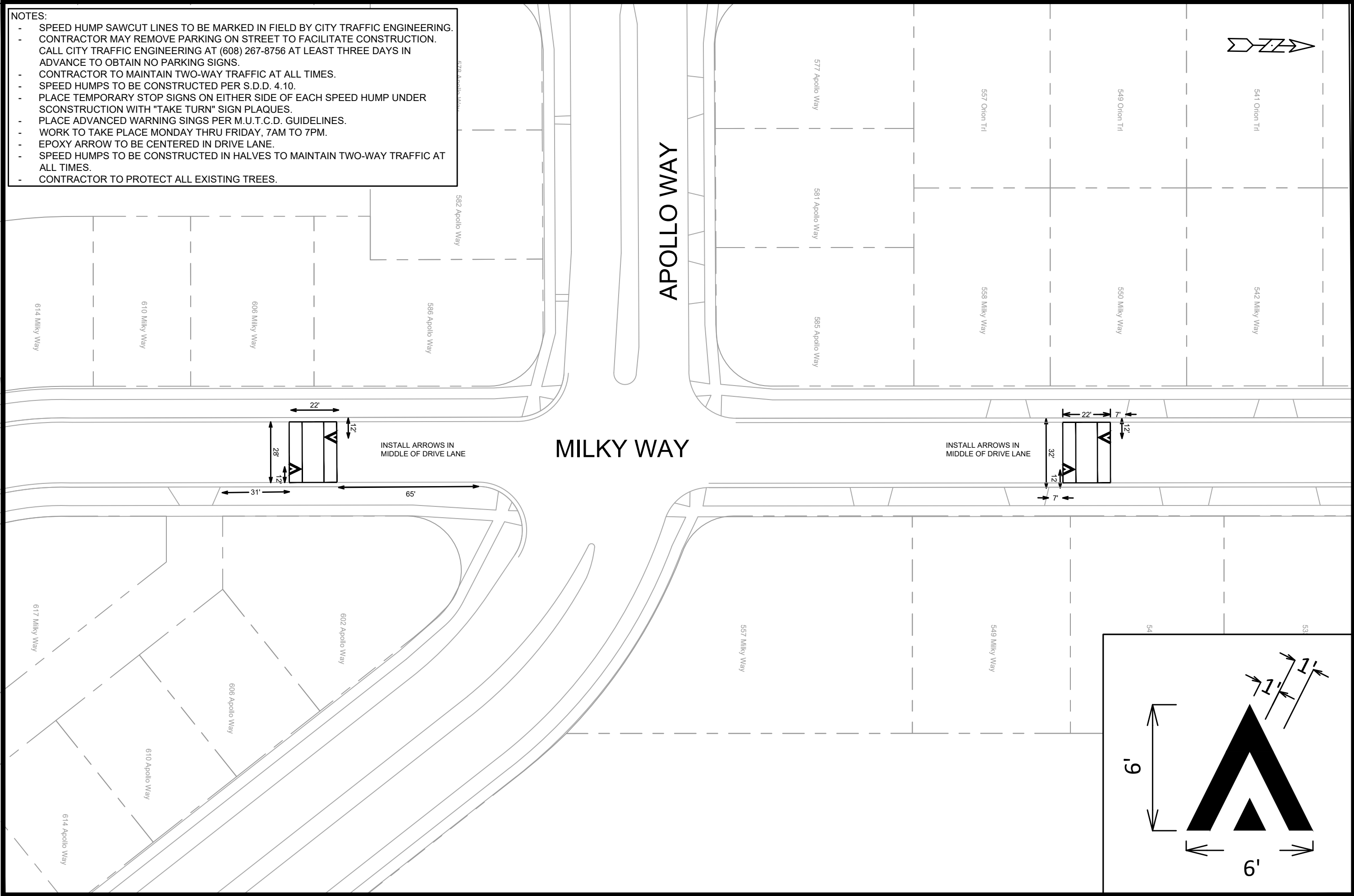

MARK	REVISION	DATE	BY
14199	14199	3/28/2024	P-8

14199
MADISON, WI
CONTRACT NO: 8695

STREET PLAN - MILKY WAY
SAFE STREETS MADISON 2024

M:\DESIGN\Projects\14199\CAD\Traffic\SSM 2024 - LMC\Milky Way - Speed Humps - SSM 2024.dwg

14199
P-8



- NOTES:
- SPEED HUMP SAWCUT LINES TO BE MARKED IN FIELD BY CITY TRAFFIC ENGINEERING.
 - CONTRACTOR MAY REMOVE PARKING ON STREET TO FACILITATE CONSTRUCTION. CALL CITY TRAFFIC ENGINEERING AT (608) 267-8756 AT LEAST THREE DAYS IN ADVANCE TO OBTAIN NO PARKING SIGNS.
 - CONTRACTOR TO MAINTAIN TWO-WAY TRAFFIC AT ALL TIMES.
 - SPEED HUMPS TO BE CONSTRUCTED PER S.D.D. 4.10.
 - PLACE TEMPORARY STOP SIGNS ON EITHER SIDE OF EACH SPEED HUMP UNDER SCONSTRUCTION WITH "TAKE TURN" SIGN PLAQUES.
 - PLACE ADVANCED WARNING SIGNS PER M.U.T.C.D. GUIDELINES.
 - WORK TO TAKE PLACE MONDAY THRU FRIDAY, 7AM TO 7PM.
 - EPOXY ARROW TO BE CENTERED IN DRIVE LANE.
 - SPEED HUMPS TO BE CONSTRUCTED IN HALVES TO MAINTAIN TWO-WAY TRAFFIC AT ALL TIMES.
 - CONTRACTOR TO PROTECT ALL EXISTING TREES.

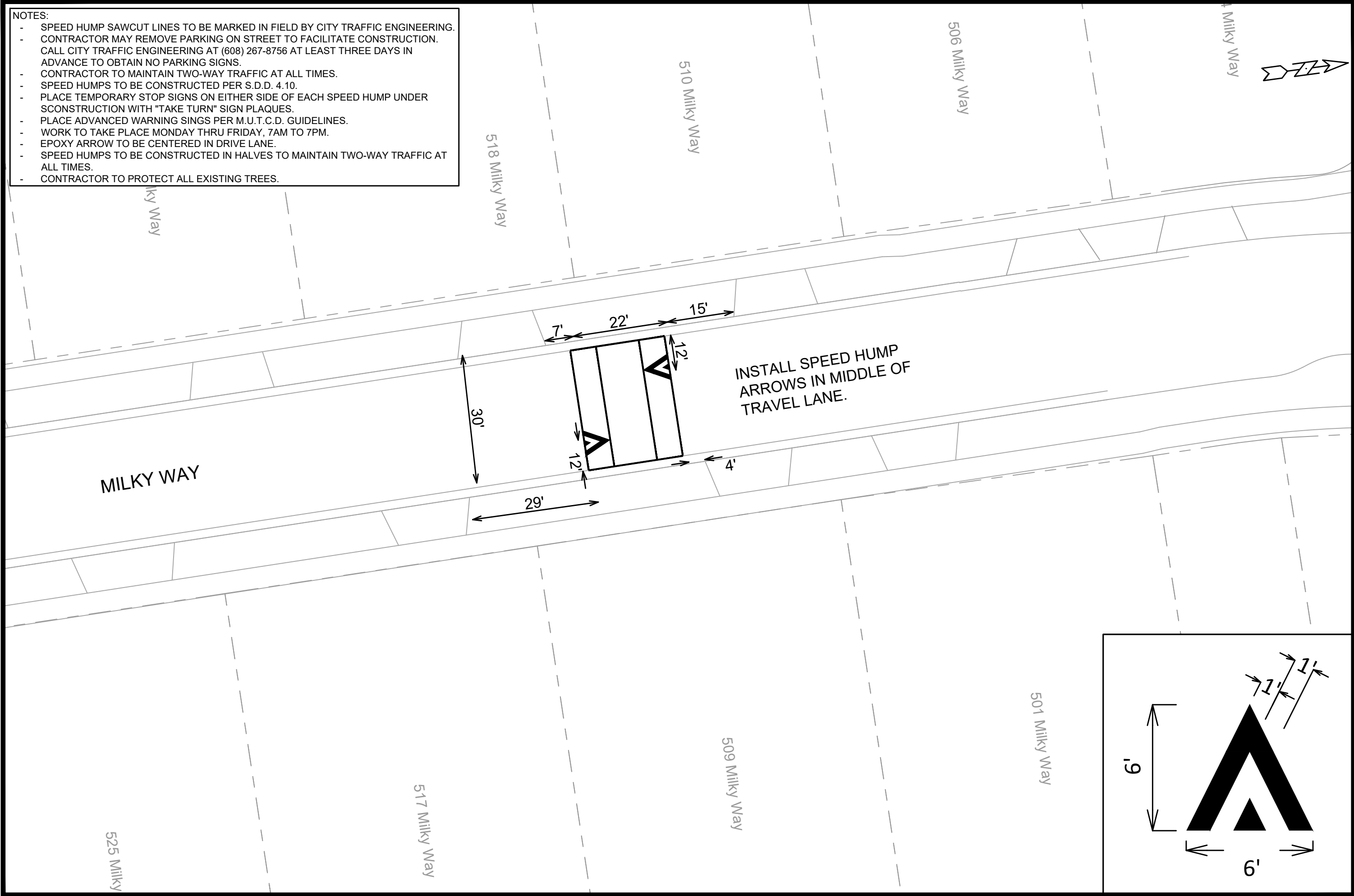

INSTALL SPEED HUMP
ARROWS IN MIDDLE OF
TRAVEL LANE.

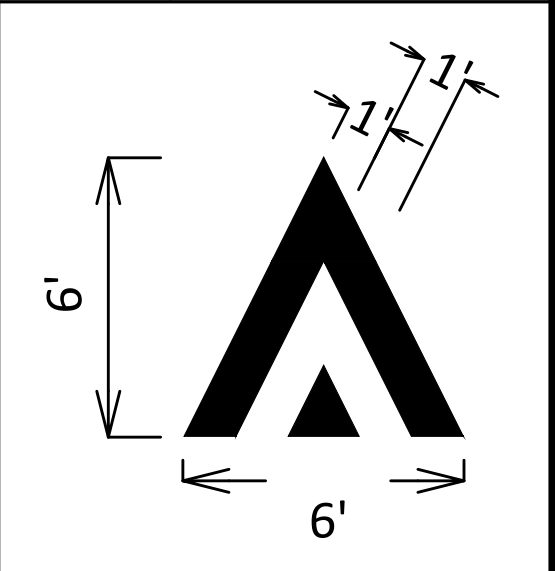

MARK	REVISION	DATE	BY
14199	3/28/2024 6:44 PM		
Designed By: ##	Scale: 1/20		P-9

14199
MADISON, WI
8695
CONTRACT NO:

STREET PLAN - MILKY WAY
SAFE STREETS MADISON 2024
M:\DESIGN\Projects\14199\CAD\Traffic\SSM 2024 - LMC\Milky Way - Speed Humps - SSM 2024.dwg

14199
P-9

- NOTES:
- SPEED HUMP SAWCUT LINES TO BE MARKED IN FIELD BY CITY TRAFFIC ENGINEERING.
 - CONTRACTOR MAY REMOVE PARKING ON STREET TO FACILITATE CONSTRUCTION. CALL CITY TRAFFIC ENGINEERING AT (608) 267-8756 AT LEAST THREE DAYS IN ADVANCE TO OBTAIN NO PARKING SIGNS.
 - CONTRACTOR TO MAINTAIN TWO-WAY TRAFFIC AT ALL TIMES.
 - SPEED HUMPS TO BE CONSTRUCTED PER S.D.D. 4.10.
 - PLACE TEMPORARY STOP SIGNS ON EITHER SIDE OF EACH SPEED HUMP UNDER SCONSTRUCTION WITH "TAKE TURN" SIGN PLAQUES.
 - PLACE ADVANCED WARNING SIGNS PER M.U.T.C.D. GUIDELINES.
 - WORK TO TAKE PLACE MONDAY THRU FRIDAY, 7AM TO 7PM.
 - EPOXY ARROW TO BE CENTERED IN DRIVE LANE.
 - SPEED HUMPS TO BE CONSTRUCTED IN HALVES TO MAINTAIN TWO-WAY TRAFFIC AT ALL TIMES.
 - CONTRACTOR TO PROTECT ALL EXISTING TREES.

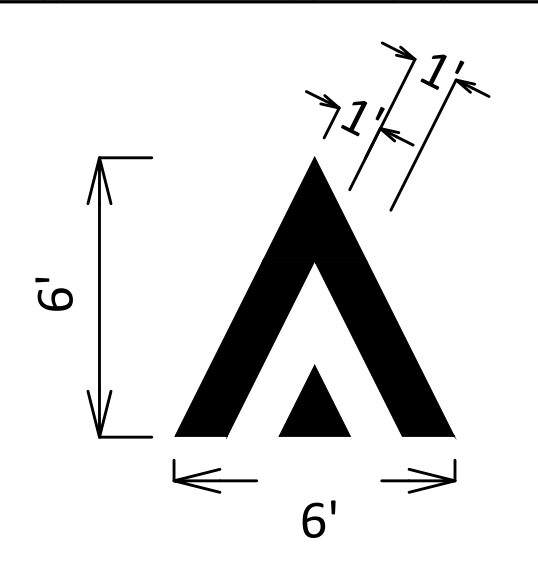
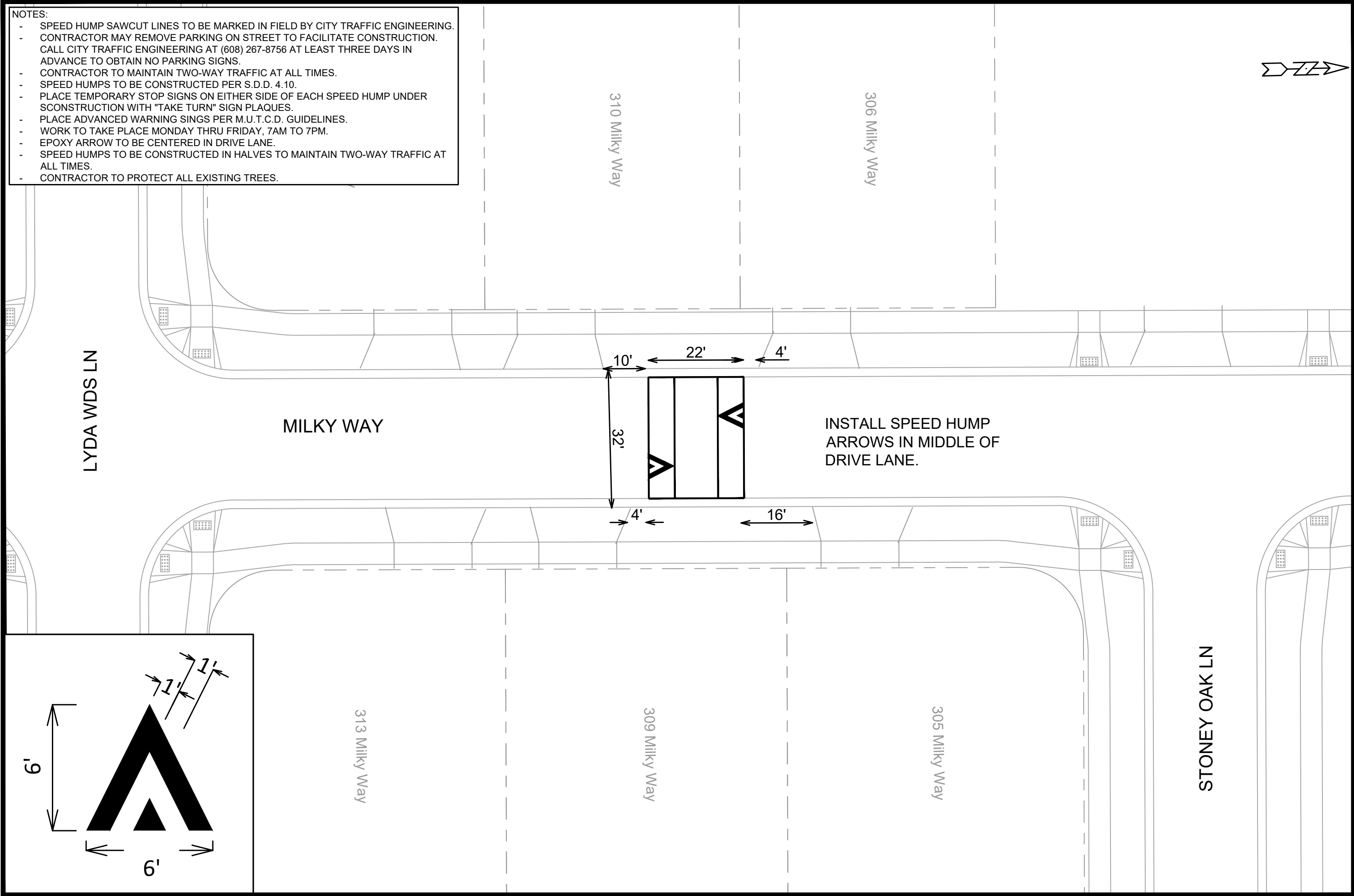
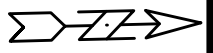

MARK	REVISION	DATE	BY
14199			

Designed By: ##
14199

Date: 3/28/2024 6:46 PM
Scale: 1:20

P-10

14199
MADISON, WI
8695
CONTRACT NO:

STREET PLAN - MILKY WAY
SAFE STREETS MADISON 2024

M:\DESIGN\Projects\14199\CAD\Traffic\SSM 2024 - LMC\Milky Way - Speed Humps - SSM 2024.dwg

14199
P-10

ISLAND DETAIL

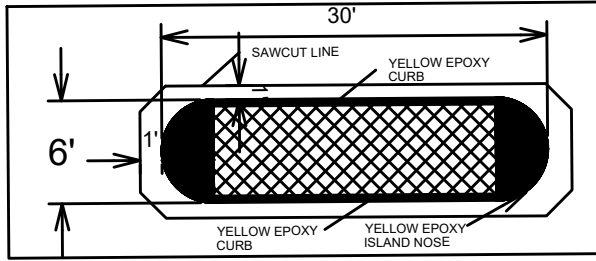

- NOTES:**
- TYPE "E" CURB ON ISLANDS
 - MOUNTABLE MEDIAN NOSES ON ISLAND ENDS PER SDD 3.13
 - CENTER OF ISLANDS TO BE STAMPED & COLORED CONCRETE "NATURAL BARK" COLOR
 - ISLAND SAWCUT LINES TO BE MARKED IN FIELD BY CITY TRAFFIC ENGINEERING.

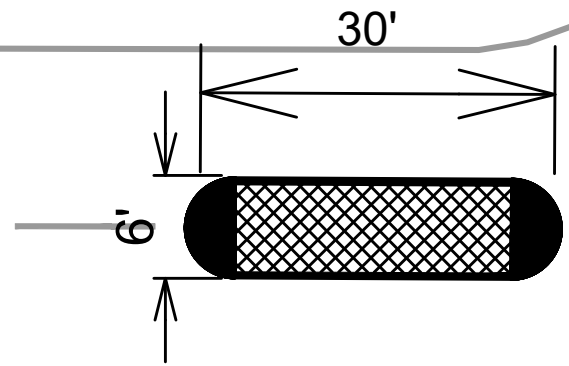

DUNWOODY DR

MOORLAND RD

MARK	REVISION	DATE	BY

Designed By: ##
14199
Date: 3/28/2024 6:46 PM
Scale: 1/20
P-11

14199
MADISON, WI
8695
CONTRACT NO:



14199
P-11

STREET PLAN - MOORLAND RD
SAFE STREETS MADISON 2024
M:\DESIGN\Projects\14199\CAD\Traffic\SSM 2024 - AHSafe Streets Madison 2024--14199 - AH autocad.dwg

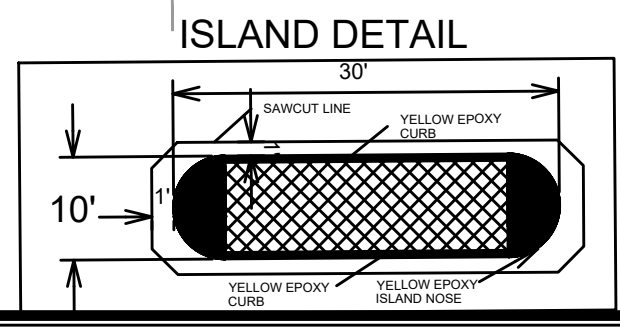
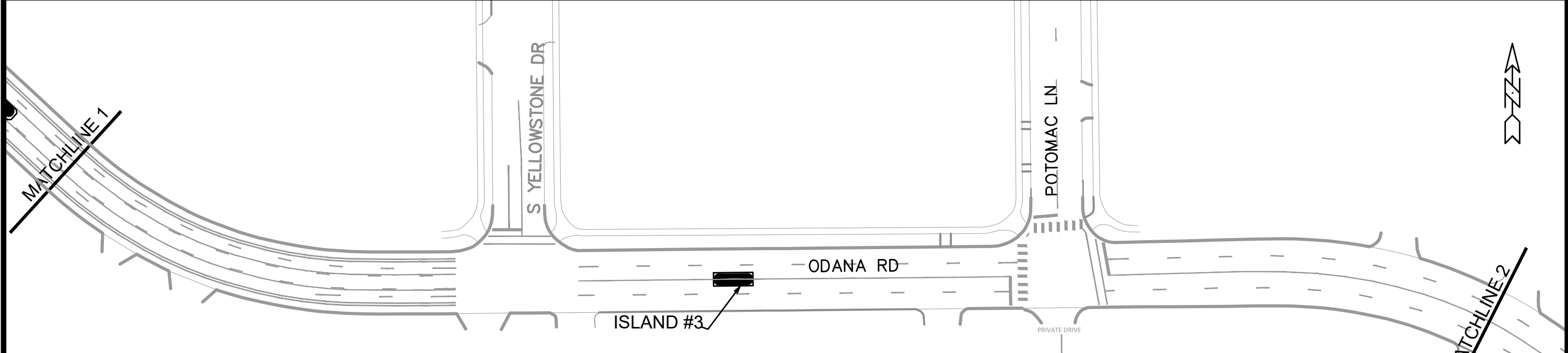
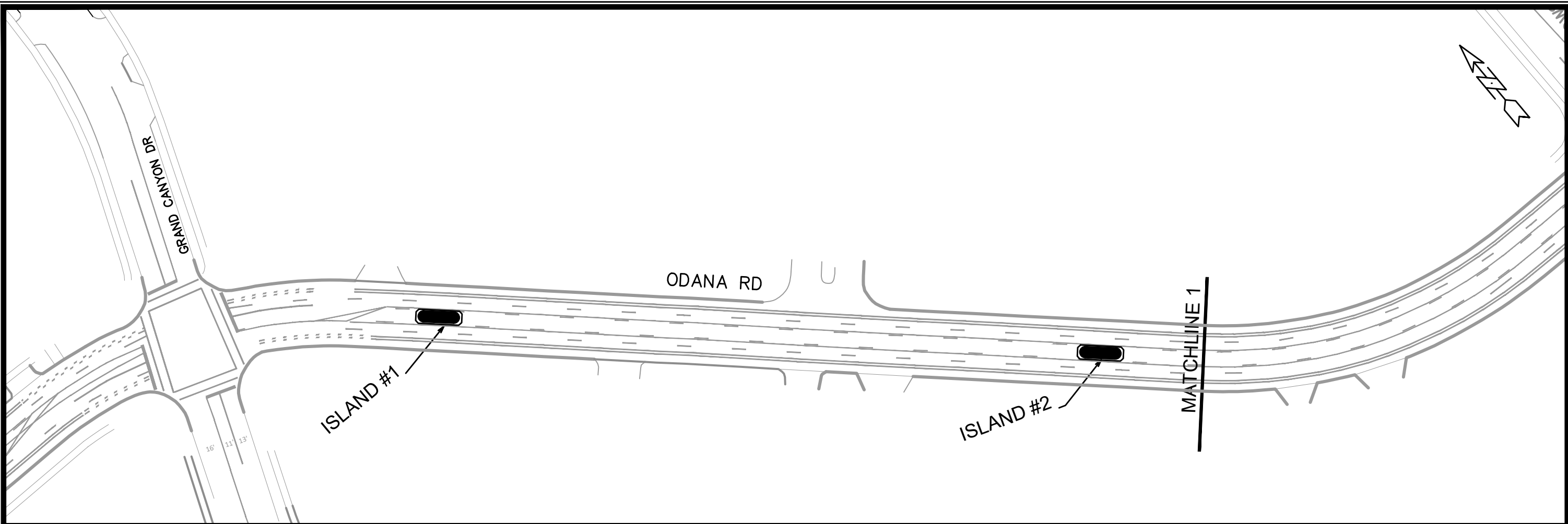

NOTES:
 -TYPE "E" CURB ON ISLANDS
 -MOUNTABLE MEDIAN NOSES ON ISLAND ENDS PER SDD 3.13
 -CENTER OF ISLANDS TO BE STAMPED & COLORED CONCRETE
 -"NATURAL BARK" COLOR
 -ISLAND SAWCUT LINES TO BE MARKED IN FIELD BY CITY TRAFFIC ENGINEERING.

MARK	REVISION	DATE	BY
14199	3/28/2024	6:46 PM	Custom
Designed By: ##			Scale: Custom
14199			P-13

STREET PLAN - ODANA RD
 SAFE STREETS MADISON 2024
 14199
 MADISON, WI
 8695
 CONTRACT NO: AHISafe Streets Madison 2024--14199 - AH autocad.dwg



14199
 P-13

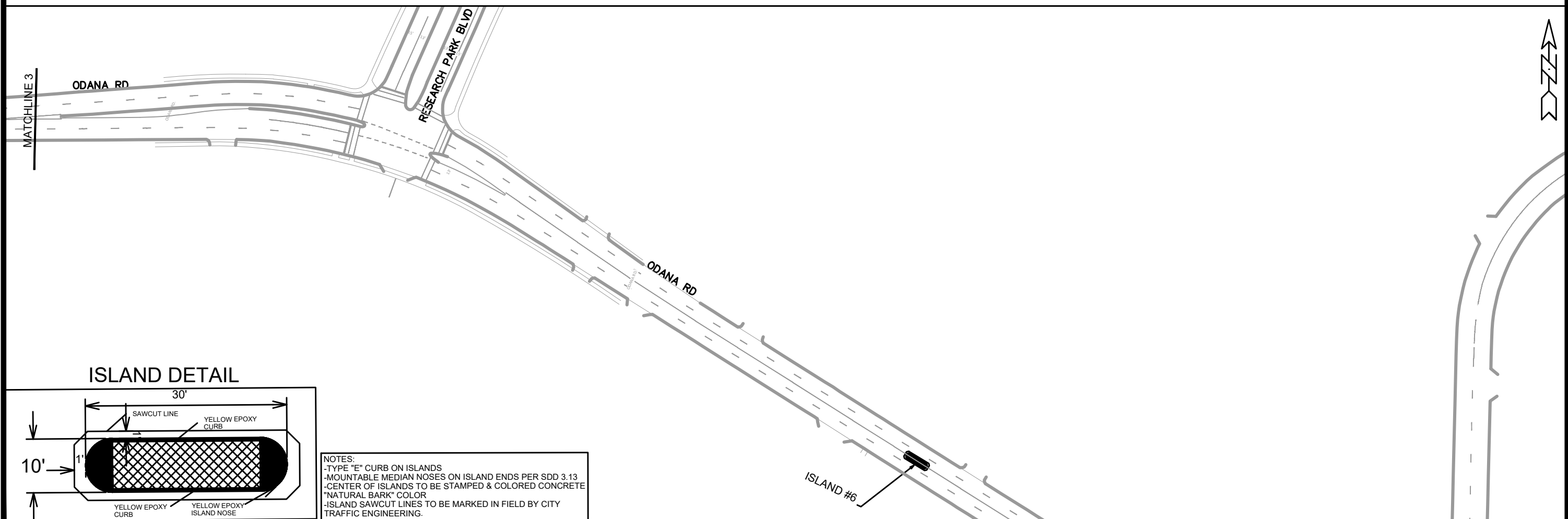
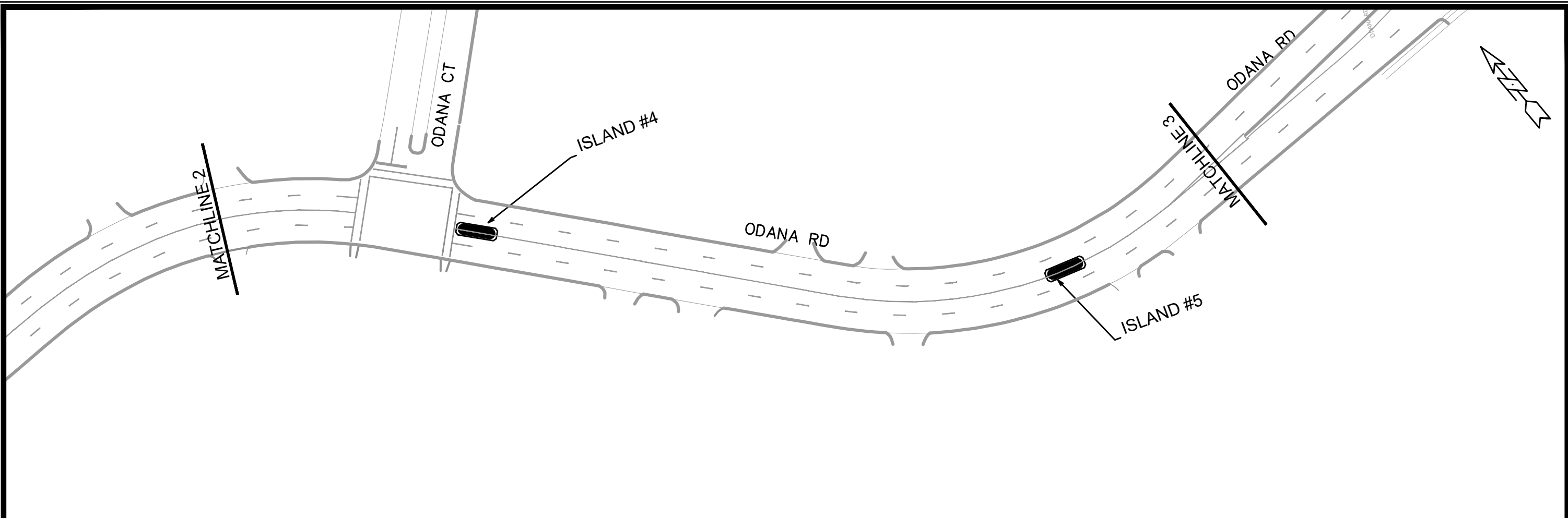

ISLAND DETAIL

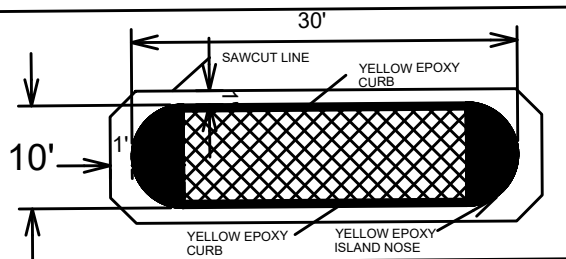

- NOTES:**
- TYPE "E" CURB ON ISLANDS
 - MOUNTABLE MEDIAN NOSES ON ISLAND ENDS PER SDD 3.13
 - CENTER OF ISLANDS TO BE STAMPED & COLORED CONCRETE "NATURAL BARK" COLOR
 - ISLAND SAWCUT LINES TO BE MARKED IN FIELD BY CITY TRAFFIC ENGINEERING.

MARK	REVISION	DATE	BY
14199	14199	3/28/2024	6:46 PM

Designed By: ###
Scale: Custom
P-14

14199
MADISON, WI
8695
CONTRACT NO: 14199



14199
P-14

STREET PLAN - ODANA RD
SAFE STREETS MADISON 2024

M:\DESIGN\Projects\14199\CAD\Traffic\SSM 2024 - AHSafe Streets Madison 2024--14199 - AH autocad.dwg

- NOTES:**
- SAWCUT LINES TO BE MARKED IN FIELD BY CITY TRAFFIC ENGINEERING.
 - CONTRACTOR MAY REMOVE PARKING ON STREET TO FACILITATE CONSTRUCTION. CAL CITY TRAFFIC ENGINEERING AT (608) 267-8756 AT LEAST THREE DAYS IN ADVANCE TO OBTAIN NO PARKING SIGNS.
 - PLACE TEMPORARY STOP SIGNS ON EITHER SIDE OF EACH SPEED HUMP UNDER CONSTRUCTION WITH "TAKE TURN" SIGN PLAQUES.
 - PLACE ADVANCED WARNING SIGNS PER M.U.T.C.D. GUIDELINES.
 - WORK TO TAKE PLACE MONDAY THRU FRIDAY, 7AM TO 7PM.
 - SPEED HUMPS TO BE CONSTRUCTED PER S.D.D. 4.10.
 - SPEED HUMPS TO BE CONSTRUCTED DURING SUMMER BREAK (MIDDLE OF JUNE TO END OF AUGUST).
 - EPOXY ARROW TO BE CENTERED IN MIDDLE OF DRIVE LANE.
 - SPEED HUMPS TO BE CONSTRUCTED IN HALVES TO MAINTAIN TWO-WAY TRAFFIC AT ALL TIMES.
 - CONTRACTOR TO PROTECT ALL EXISTING TREES.

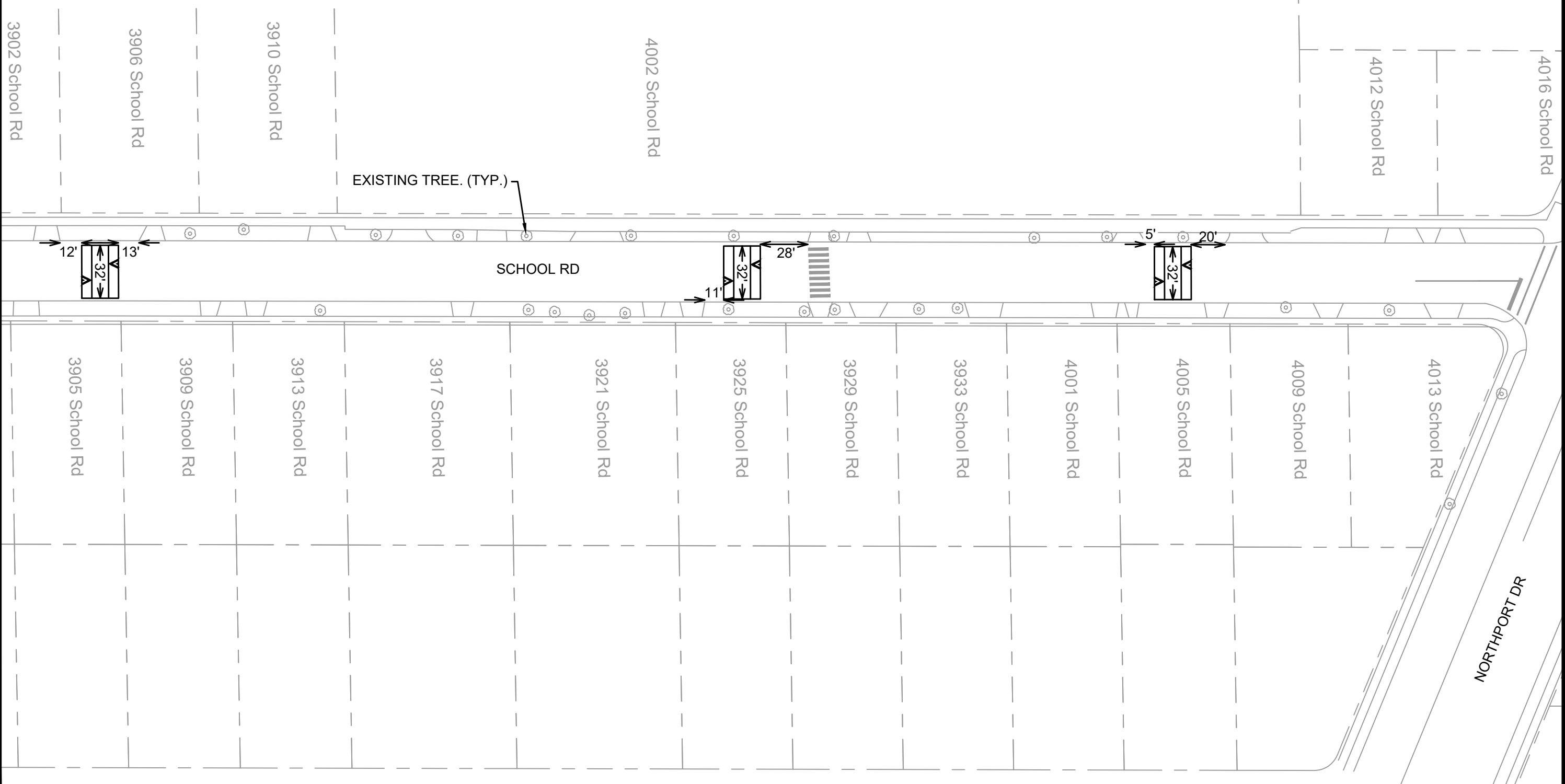
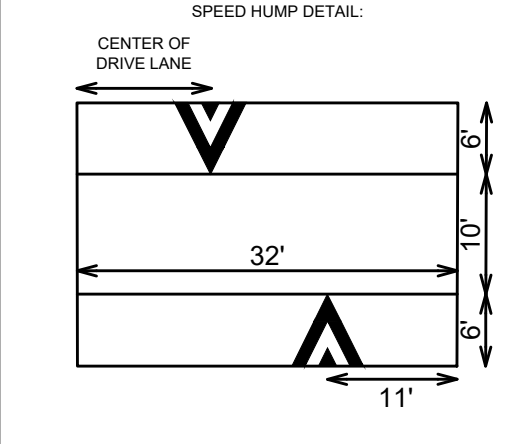

MARK	REVISION	DATE	BY
14199	14199	3/28/2024 6:46 PM	LMC

Scale: 1"=60'

14199
 MADISON, WI
 53706
 CONTRACT NO: 14199



NOTES:

- SPEED HUMP SAWCUT LINES TO BE MARKED IN FIELD BY CITY TRAFFIC ENGINEERING.
- CONTRACTOR MAY REMOVE PARKING ON STREET TO FACILITATE CONSTRUCTION. CALL CITY TRAFFIC ENGINEERING AT (608) 267-8756 AT LEAST THREE DAYS IN ADVANCE TO OBTAIN NO PARKING SIGNS.
- CONTRACTOR TO MAINTAIN TWO-WAY TRAFFIC AT ALL TIMES.
- SPEED HUMPS TO BE CONSTRUCTED PER S.D.D. 4.10.
- SPEED HUMPS TO BE CONSTRUCTED DURING SUMMER BREAK (MIDDLE OF JUNE TO END OF AUGUST).
- PLACE TEMPORARY STOP SIGNS ON EITHER SIDE OF EACH SPEED HUMP UNDER CONSTRUCTION WITH "TAKE TURN" SIGN PLAQUES.
- PLACE ADVANCED WARNING SIGNS PER M.U.T.C.D. GUIDELINES.
- WORK TO TAKE PLACE MONDAY THRU FRIDAY, 7AM TO 7PM.
- EPOXY ARROW TO BE CENTERED IN DRIVE LANE.
- SPEED HUMPS TO BE CONSTRUCTED IN HALVES TO MAINTAIN TWO-WAY TRAFFIC AT ALL TIMES.
- CONTRACTOR TO PROTECT ALL EXISTING TREES.

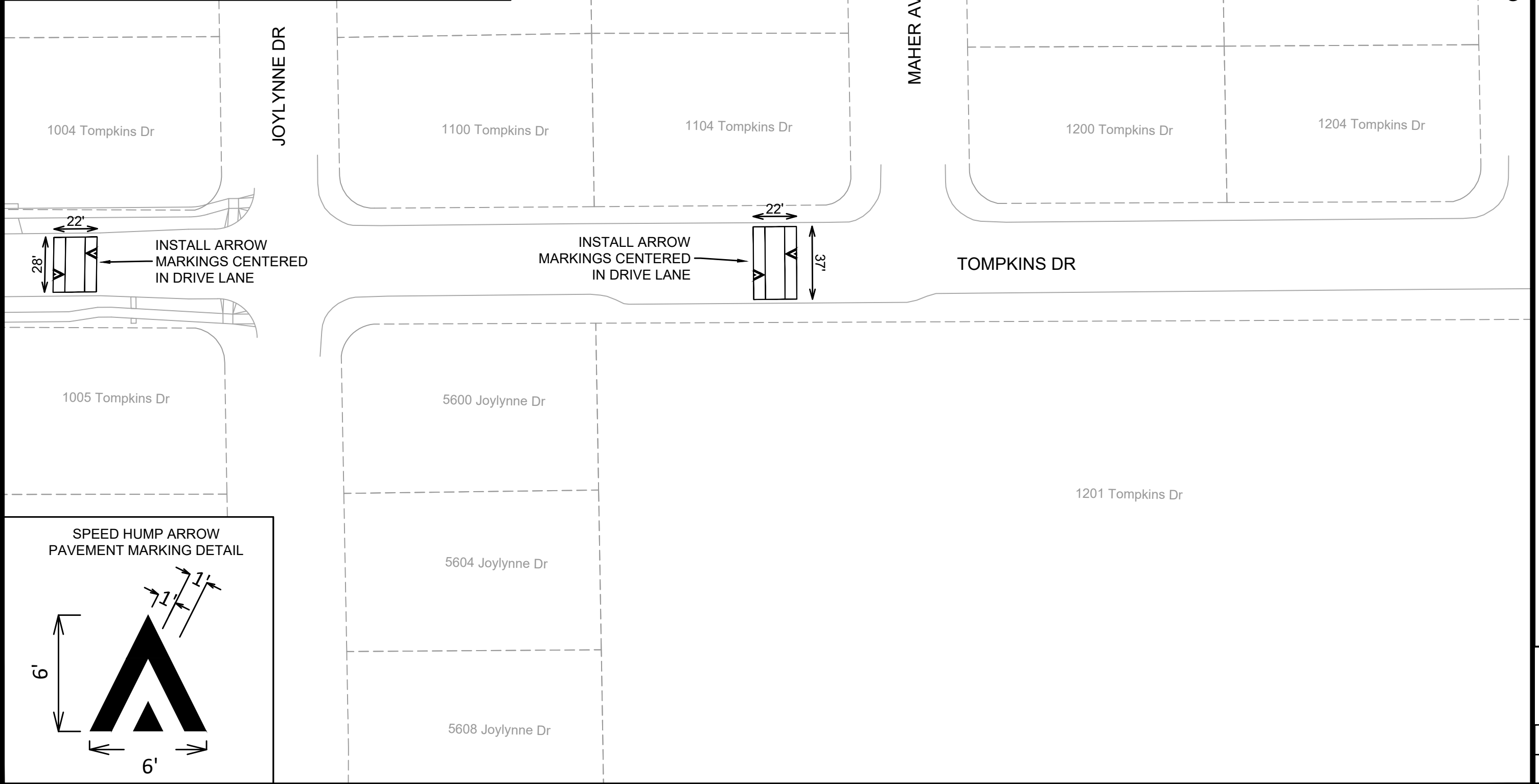

MARK	REVISION	DATE	BY
14199	14199	3/28/2024 6:48 PM	1:50

STREET PLAN - TOMPKINS DR
 14199
 MADISON, WI
 CONTRACT NO: 8695
 M:\DESIGN\Projects\14199\CAD\Traffic\SSM 2024 - LMC\Tompkins Dr - Speed Humps - SSM 2024.dwg



- NOTES:
- SPEED HUMP SAWCUT LINES TO BE MARKED IN FIELD BY CITY TRAFFIC ENGINEERING.
 - CONTRACTOR MAY REMOVE PARKING ON STREET TO FACILITATE CONSTRUCTION. CALL CITY TRAFFIC ENGINEERING AT (608) 267-8756 AT LEAST THREE DAYS IN ADVANCE TO OBTAIN NO PARKING SIGNS.
 - CONTRACTOR TO MAINTAIN TWO-WAY TRAFFIC AT ALL TIMES.
 - SPEED HUMPS TO BE CONSTRUCTED PER S.D.D. 4.10.
 - SPEED HUMPS TO BE CONSTRUCTED DURING SUMMER BREAK (MIDDLE OF JUNE TO END OF AUGUST).
 - PLACE TEMPORARY STOP SIGNS ON EITHER SIDE OF EACH SPEED HUMP UNDER CONSTRUCTION WITH "TAKE TURN" SIGN PLAQUES.
 - PLACE ADVANCED WARNING SIGNS PER M.U.T.C.D. GUIDELINES.
 - WORK TO TAKE PLACE MONDAY THRU FRIDAY, 7AM TO 7PM.
 - EPOXY ARROW TO BE CENTERED IN DRIVE LANE.
 - SPEED HUMPS TO BE CONSTRUCTED IN HALVES TO MAINTAIN TWO-WAY TRAFFIC AT ALL TIMES.
 - CONTRACTOR TO PROTECT ALL EXISTING TREES.

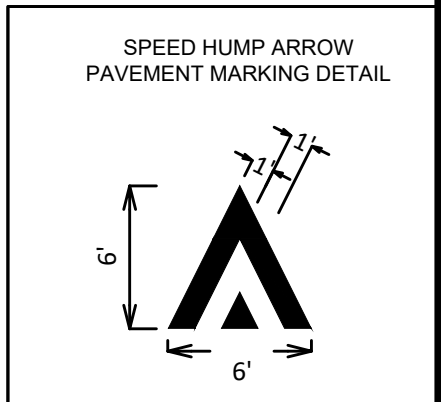
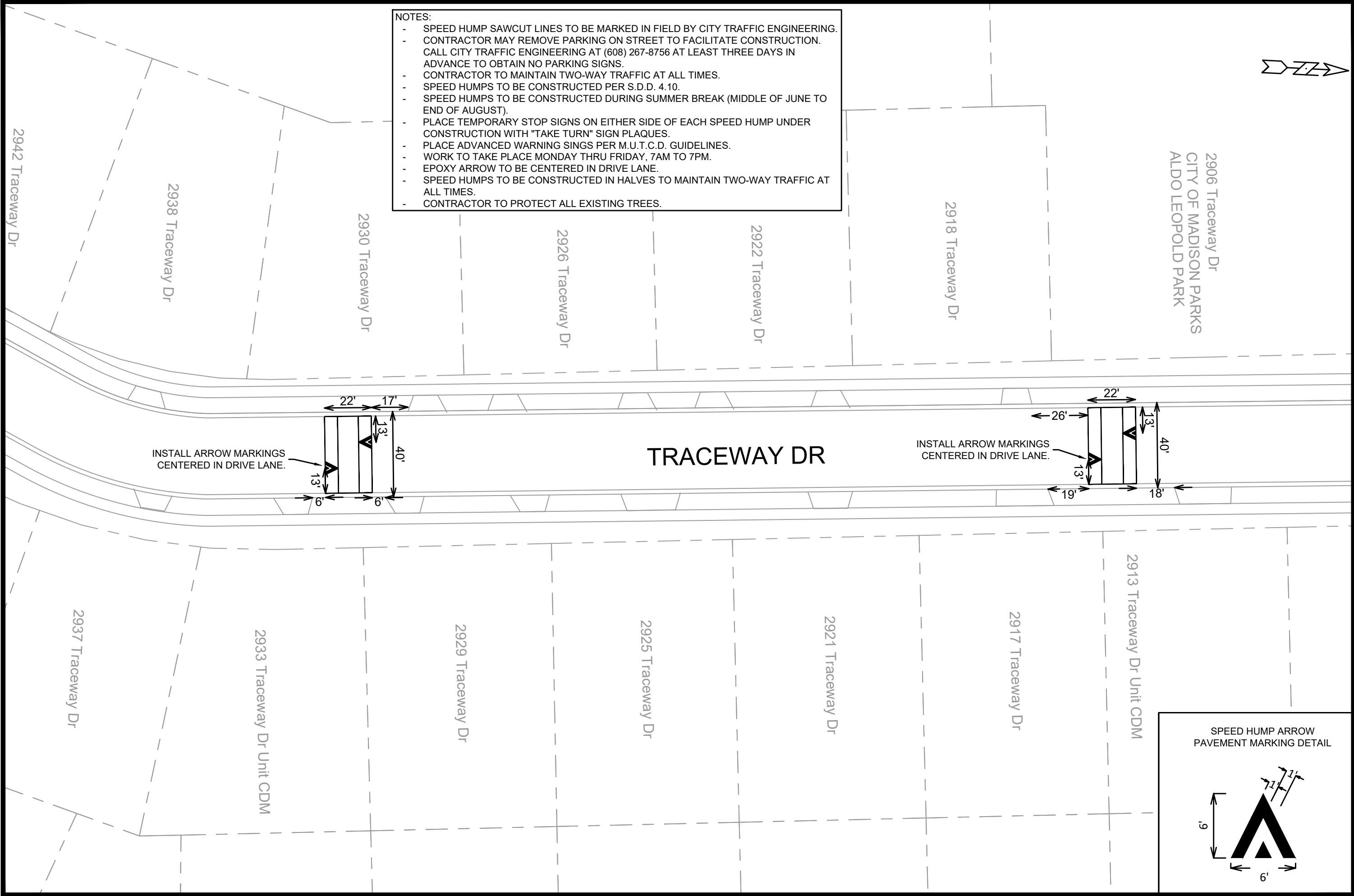

14199	MADISON, WI	8695	14199	P-17
STREET PLAN - TRACEWAY DR		CONTRACT NO:		DATE
SAFE STREETS MADISON 2024				REVISION
M:\DESIGN\Projects\14199\CAD\Traffic\SSM 2024 - LMC\Traceway Dr - Leopold Park Speed Humps - SSM 2024.dwg				Desiged By: ##
				Date: 3/28/2024 6:50 PM
				Scale: 1" = 40'
				MARK
				14199
				P-17



